



AX-X3 Auxiliary contact

1. Compliant standards

IEC60947-5

2. Compliant certification

CE

3. Major function

To be assembled with the circuit breaker to achieve long-distance signal indication for the open/close status of the circuit breaker

4. Parameters and performance

Rated operating currents under different working voltages:

Table 1

Utilization category	Rated operating voltage V	Rated operating current A
AC-12	AC 415	3
	AC 240	6
DC-12	DC 130	1
	DC 48	2
	DC 24	6

Action characteristics: Figure 1 shows the wiring diagram for auxiliary contacts. When the auxiliary contacts is open, terminals 11 and 12 is connected; When the auxiliary contacts is closed, terminals 11 and 14 is connected.

Life: Operating life of auxiliary contacts is ≥ 10000 cycles.

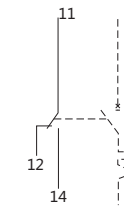
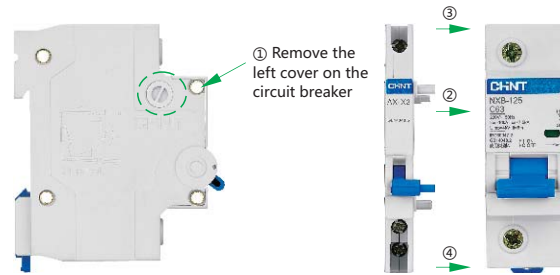

Figure 1

5. Assembly and installation of the product

AX-X3 can be assembled with NXB-125, NXB-125G series circuit breaker, with the assembly diagram shown below:

Figure 2



تهران - خیابان لاله زارنو - بالاتر از منوچهری - پاساژ البرز ۲ - طبقه اول - واحد ۲۳۵

۰۲۱-۶۶۳۴۱۰۹۰-۹۲

۰۹۳۹۶۲۹۲۰۰۱

splus.ir/peoe_iran

apararat.com/peoe_iran

www.peoe.ir

t.me/peoe_iran

instagram.com/peoe_iran

6. Dimensions and installation sizes

Figure 3

